



Smart Watering Made Easy.

*Everything You Need to
Water Your Landscape
Automatically in
3 Easy Steps*



TOOL-FREE

PRECISION WATERING

Installation & Inspiration

For Your Automatic
Watering System

Quick Start Installation Guide

Get Started!

Installation is quick, easy and tool-free. We've organized our parts by step. Grab bag number one to get started.



Hose Thread Connections



Clamp-n-Pierce™ Connection



STEP 1

- 1 - Universal Faucet Timer
- 1 - Filter/Pressure Regulator
- 1 - "Y" Connector

STEP 2

- 1 - Universal Tee
- 1 - Universal End Plug
- 1 - 50 ft. Supply Tubing
- 5 - Wire Stakes
- 10 - Goof Plugs

STEP 3

- 10 - Support Stakes
- 10 - Pre-Assembled 4 ft. Feeder Lines, 2 GPH

The System

Use your new system to water flowers, shrubs and trees.*

*Not for lawn use.

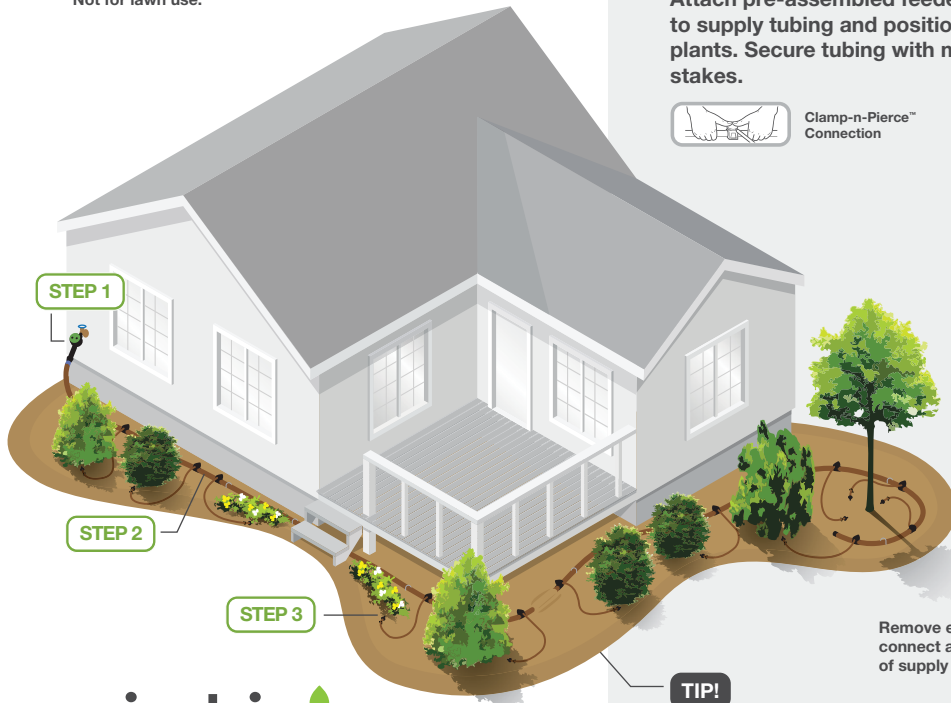

STEP 1

STEP 2

STEP 3

TIP!

Use mulch to cover or camouflage the supply tubing.

TOOL-FREE

1·2·3 easy

STEP 1

Connect the timer and pressure regulator to your outdoor faucet.

STEP 2

Connect the supply tubing to the filter/pressure regulator and lay out in the area you want to water.

STEP 3

Attach pre-assembled feeder lines to supply tubing and position near plants. Secure tubing with metal stakes.



Clamp-n-Pierce™ Connection

Outdoor Faucet



TIP!



Use the "Y" Connector to convert your faucet to two separate outlets.

Universal Faucet Timer

Filter/Pressure Regulator

Hose Thread Connections



50 ft. Supply Tubing

TIP!

Goof Plugs

Need to move a feeder line? Use a "goof plug" to fill any holes in the supply tubing.

Shown with dripper. Your kit may include bubblers.

TIP!

Feeder Lines

Use the plastic stake to position and secure each dripper.

TIP!

Connect another roll of supply tubing to expand your system.

Make sure not to use more than 200 ft. of supply tubing per faucet connection.



Smart Watering Made Easy.

Configurations and Applications

Water plants anywhere!

It's easy to customize your system to fit your landscape.

Underground (optional)

Easily bury supply tubing underground in order to water a planter box or run underneath a concrete pathway.

TIP! Supply Tubing

Make sure not to use more than 200 ft. of supply tubing per faucet connection.

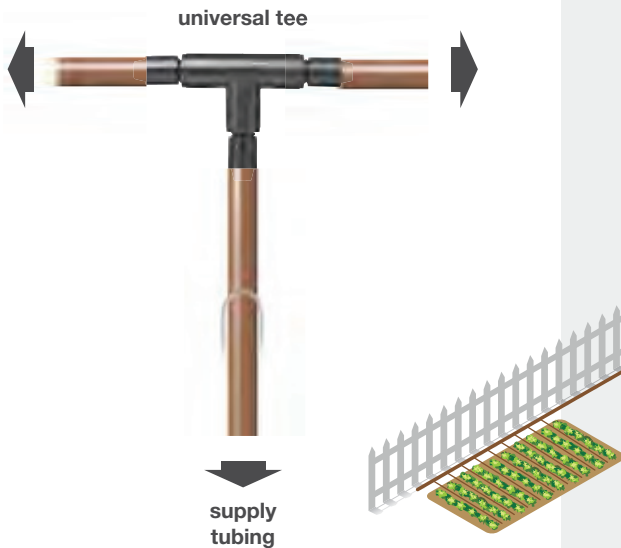

Direction and Distance

Branch supply tubing in opposite directions with a universal tee fitting and extend for long distances with extra supply tubing.

Planter Box (Away from House)

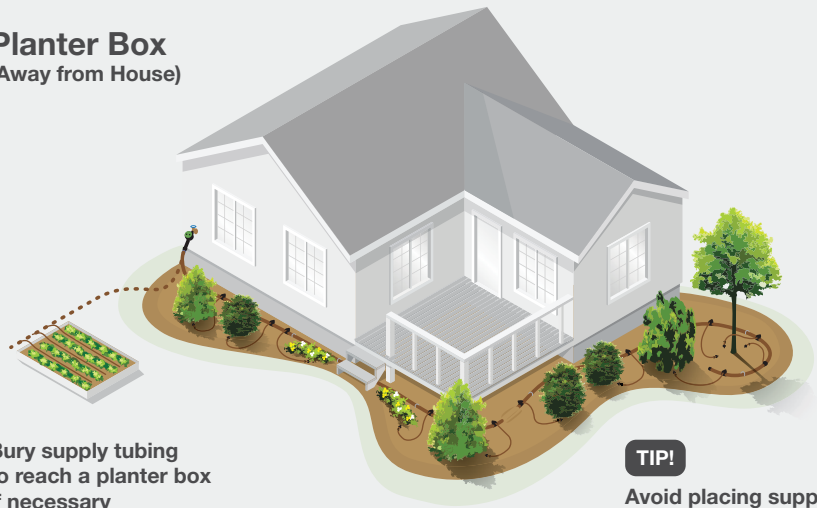

Bury supply tubing to reach a planter box if necessary

TIP!

Avoid placing supply tubing on turf that gets mowed.

For grassy areas that are mowed you can bury your supply tubing

Under Concrete Pathway

Bury supply tubing under a concrete pathway



Extended Reach

Extend your system long distances

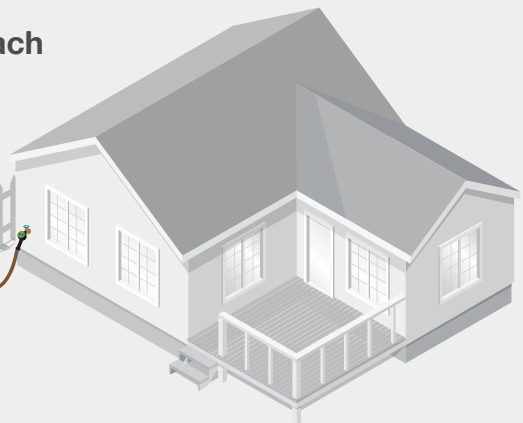

Multi-directional

Branch supply tubing in multiple directions



TIP!

Fittings are reusable.



Smart Watering Made Easy.

Specifications and Scheduling

This guide is an aid to help you get started.

Count your feeder lines!

Determine the number you need based on plant type. Arrange feeder lines next to plants as shown.



TIP! Feeder Lines

Make sure not to use more than 75 feeder lines (or 150 GPH total) per 200 ft. of supply tubing.

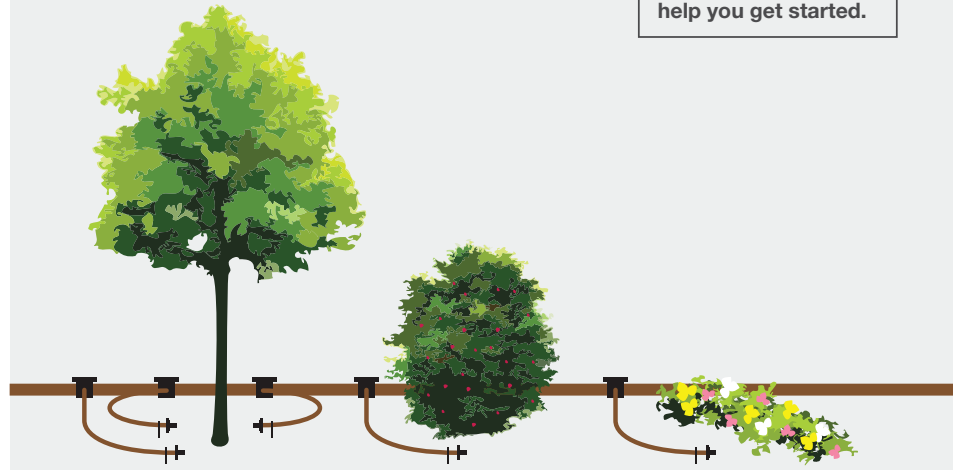

Trees

Shorter than 15 feet

3

Water Lines

Taller than 15 feet

5

Water Lines

Shrubs

Shorter than 4 feet

1

Water Line

Taller than 4 feet

2

Water Lines

Flowers and Ground Cover

1 every 12-18 inches

Water Line

Time it perfectly!

Schedule your watering times by region and the type of soil you have.



Soil Types:

SAND: Loose, sandy soil
LOAM: Soft, rich soil
CLAY: Hard, dense soil

This guide is an aid to help you get started.

Number of irrigation days per week	SOIL	1	2	3	4	5	6	7
Coastal Regions Average Summer High Temperature Less than 85° F	SAND	70 min	35 min	41 min	33 min	33 min		
	LOAM	80 min	72 min	63 min	46 min			
	CLAY	92 min	81 min	72 min				
Inland Regions Average Summer High Temperature 85° F to 95° F	SAND		43 min	29 min	40 min	55 min	45 min	
	LOAM	96 min	92 min	62 min	77 min	62 min		
	CLAY	110 min	108 min	118 min	89 min			
Desert Regions Average Summer High Temperature Greater than 95° F	SAND		60 min	40 min	54 min	43 min	60 min	50 min
	LOAM		68 min	80 min	60 min	80 min	68 min	
	CLAY		78 min	96 min	115 min	92 min		

Seasonal run times:

Winter

Spring/Fall

Summer



Smart Watering Made Easy.

Expansion and Customization

Expand your system!

- Additional supply tubing is available in 50 ft. lengths.
- Add feeder lines to water more plants.
- Fittings make it easy to customize the system to fit your landscape.

TOOL-FREE

1·2·3
easy

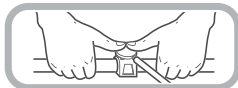
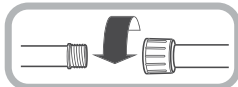

Hose Thread Connections



STEP 2

50 ft. Supply Tubing
Pre-assembled – includes fittings



Clamp-n-Pierce™ Connection



STEP 3

4 ft. Feeder Lines, 2 GPH
Pre-assembled – includes stakes



STEP 2

Fittings, Stakes and Plugs

Includes:
1 - Universal Tee Connector
1 - Universal Endcap
5 - Wire Hook Stakes
10 - Goof Plugs

Learn more!

Go to raindrip.com to learn more about drip irrigation including the different types of feeder lines you can use to customize water flow rates.

Where to buy?

- Online: raindrip.com
- In-Store: at select locations

raindrip.com



raindrip

Smart Watering Made Easy.

BEST FOR WATERING:
large shrubs and trees



Clamp-n-Pierce™ Connection



Bubblers

BEST FOR WATERING:
containers, small plants and shrubs



Clamp-n-Pierce™ Connection



Drippers

BEST FOR WATERING:
ground cover and flower beds



Clamp-n-Pierce™ Connection



Sprayers

BEST FOR WATERING:
ground cover and flower beds



Clamp-n-Pierce™ Connection



Dripper Lines