

SPECIFICATIONS:

- AVAILABLE DIAL SIZES: 1 1/2", 2", 2 1/2", 3 1/2", 4 1/2"
- AVAILABLE CONNECTION SIZES:
1/8"NPT on 1 1/2"Dial Size
1/4"NPT on 2" Thru 4 1/2"Dial Sizes
- Black Steel Case, Black Bezel
- Phosphor Bronze Bourdon Tube
- Brass Socket
- Large Orifice / No Restrictor (less likely to clog)
- Glass Lens
- 3-2-3 % Accuracy
- Dry Non-Fillable
- Ambient Temperature: -50 to 160°F
- Dual scale: PSI & Bar (x100=kpa) standard
Single scale: PSI only available
Other: by special request

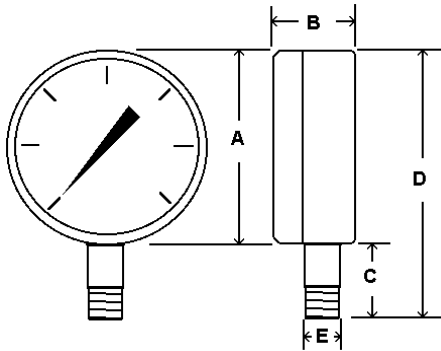

SE-101D

	1 1/2"	2"	2 1/2"	3 1/2"	4 1/2"
A	1.64"/42mm	2.07"/53mm	2.50"/63mm	3.53"/90mm	4.89"/124mm
B	.93"/24mm	1.03"/26mm	1.17"/30mm	1.14"/29mm	1.16"/29mm
C	.63"/16mm	.83"/21mm	.86"/22mm	1.02"/26mm	1.16"/30mm
D	2.27"/58mm	2.90"/74mm	3.36"/85mm	4.55"/116mm	6.05"/154mm
E	1/8npt	1/8 or 1/4npt	1/4npt	1/4npt	1/4npt

PART NUMBER SYSTEM

SE-101D-#

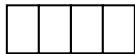

Dial Size

- 15 = 1 1/2"
- 20 = 2"
- 25 = 2 1/2"
- 35 = 3 1/2"
- 45 = 4 1/2"

Connection Size

- 8 = 1/8" MNPT
- 4 = 1/4" MNPT

RANGE CODE

CODE	RANGE	MAJOR IN	MINOR IN
C	0/30 PSI	5 psi	.5 psi
With	2 Bar (x100 = kPa)	.5 bar	.05 bar
D	0/60 PSI	10 psi	1 psi
With	4 Bar (x100 = kPa)	1 bar	.1 bar
E	0/100 PSI	20 psi	.2 psi
With	7 Bar (x100 = kPa)	1 bar	.1 bar
F	0/160 PSI	20 psi	.2 psi
With	11 Bar (x100 = kPa)	2 bar	.2 bar
G	0/200 PSI	40 psi	5 psi
With	14 Bar (x100 = kPa)	2 bar	.2 bar
H	0/300 PSI	50 psi	5 psi
With	20 Bar (x100 = kPa)	5 bar	.5 bar